

INSTRUCTION

For connection between
Tower Pro and Solis S6-EH3P10K-H(PRO)

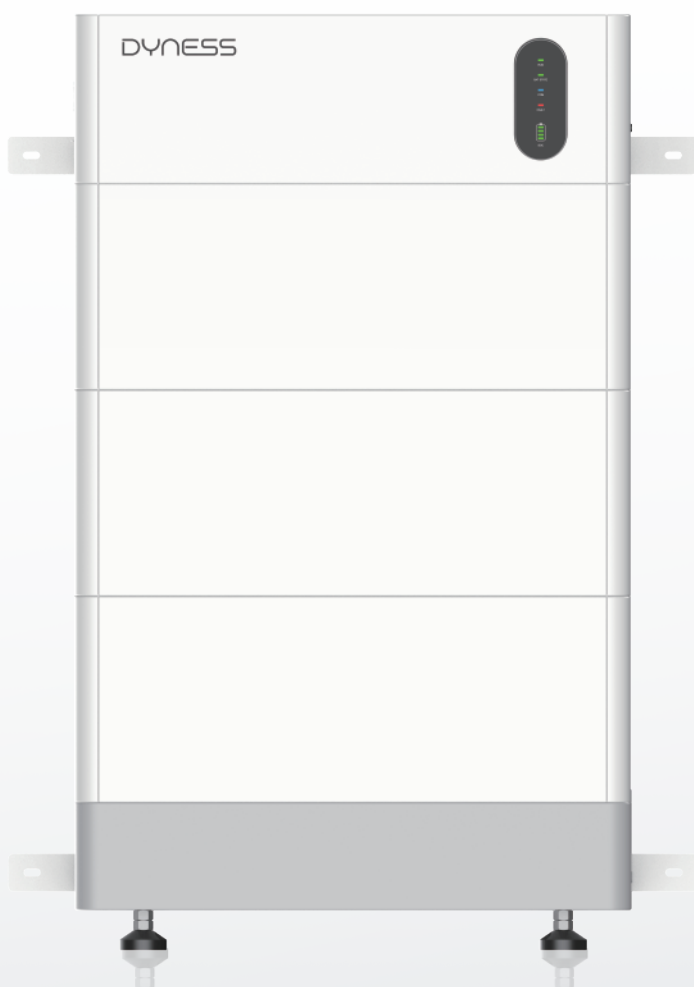

Tower Pro

Quick Installation Guide

Important Safety Instruction

Notice

This is an instruction for connection and commissioning between Tower Pro and Solis S6-EH3P10K-H(PRO).

For details of the connection and commissioning, please go to user manual of the battery and the Solis S6-EH3P10K-H(PRO) if you cannot find it in this instruction.

Applicable Product type

NO.	Name	Model / Type
A	Dyness Battery model	Tower Pro TP7 ESS unit Tower Pro TP11 ESS unit Tower Pro TP15 ESS unit Tower Pro TP19 ESS unit
B	Solis Inverter Type	S6-EH3P5K/6K/8K/10K-H(PRO) RHI-3P5K/6K/8K/10K-HVES-5G RHI-1P7.6K-HVES-5G

Installation Steps

Step1: Install according to the Tower Pro user manual. Take Tower 1 Pro TP11 for example.

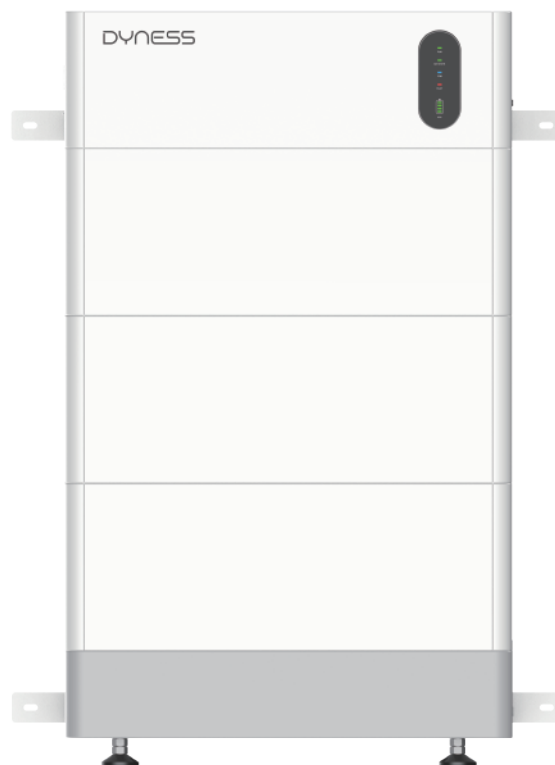

Step2: Refer to user manual to connect energy meter, grid, loads, etc. to Solis inverter.

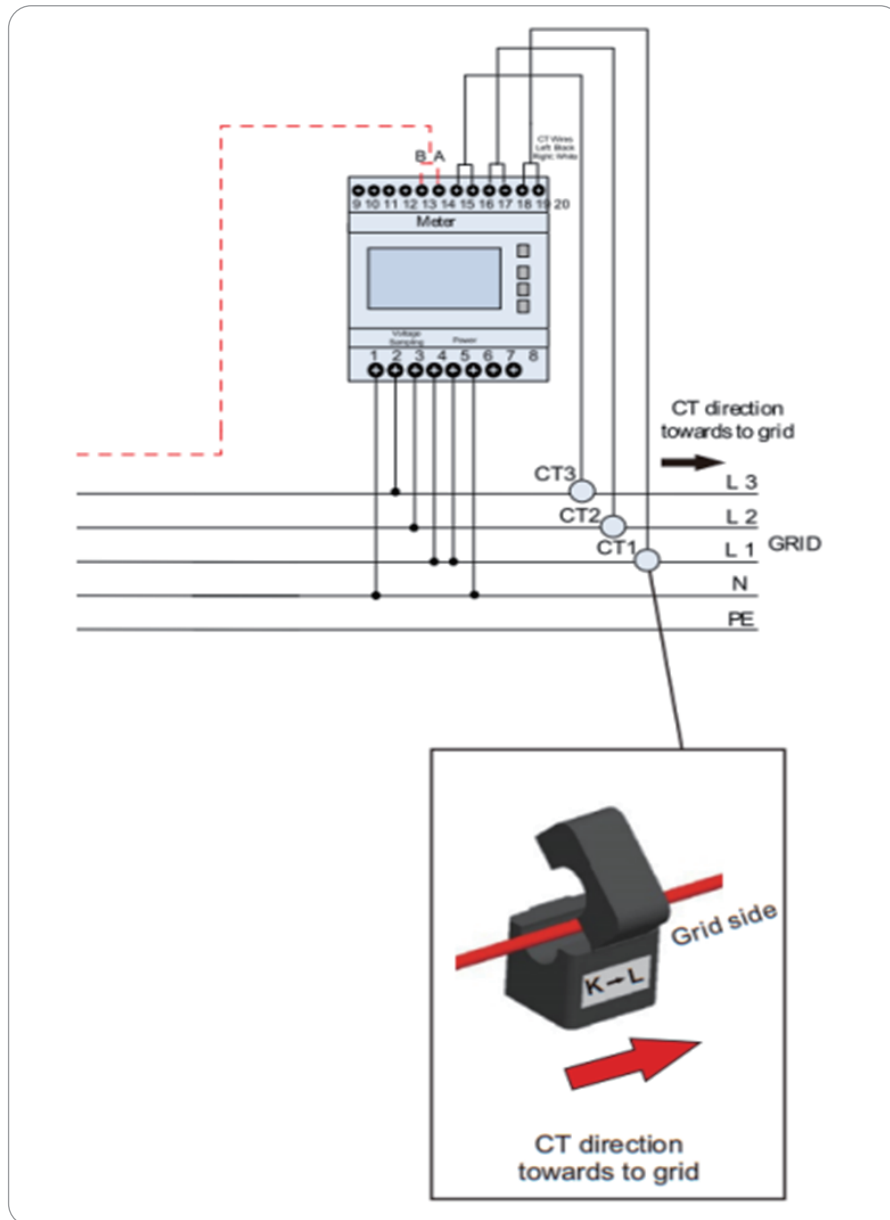

Step3: Connect the battery power cables to inverter.

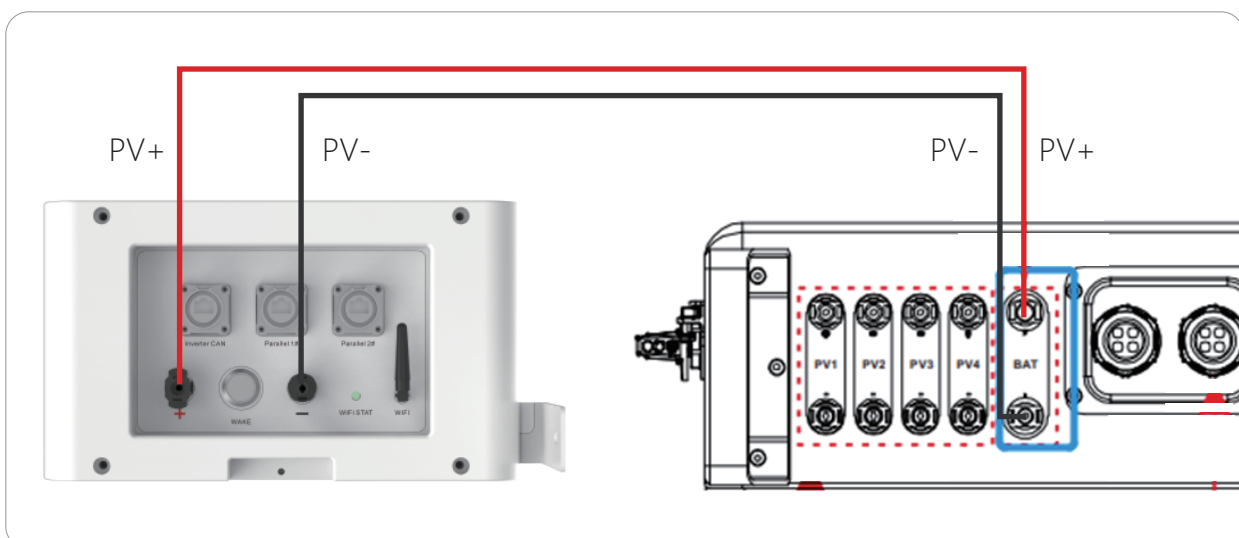

Step4: Connect the battery communication cable to inverter.

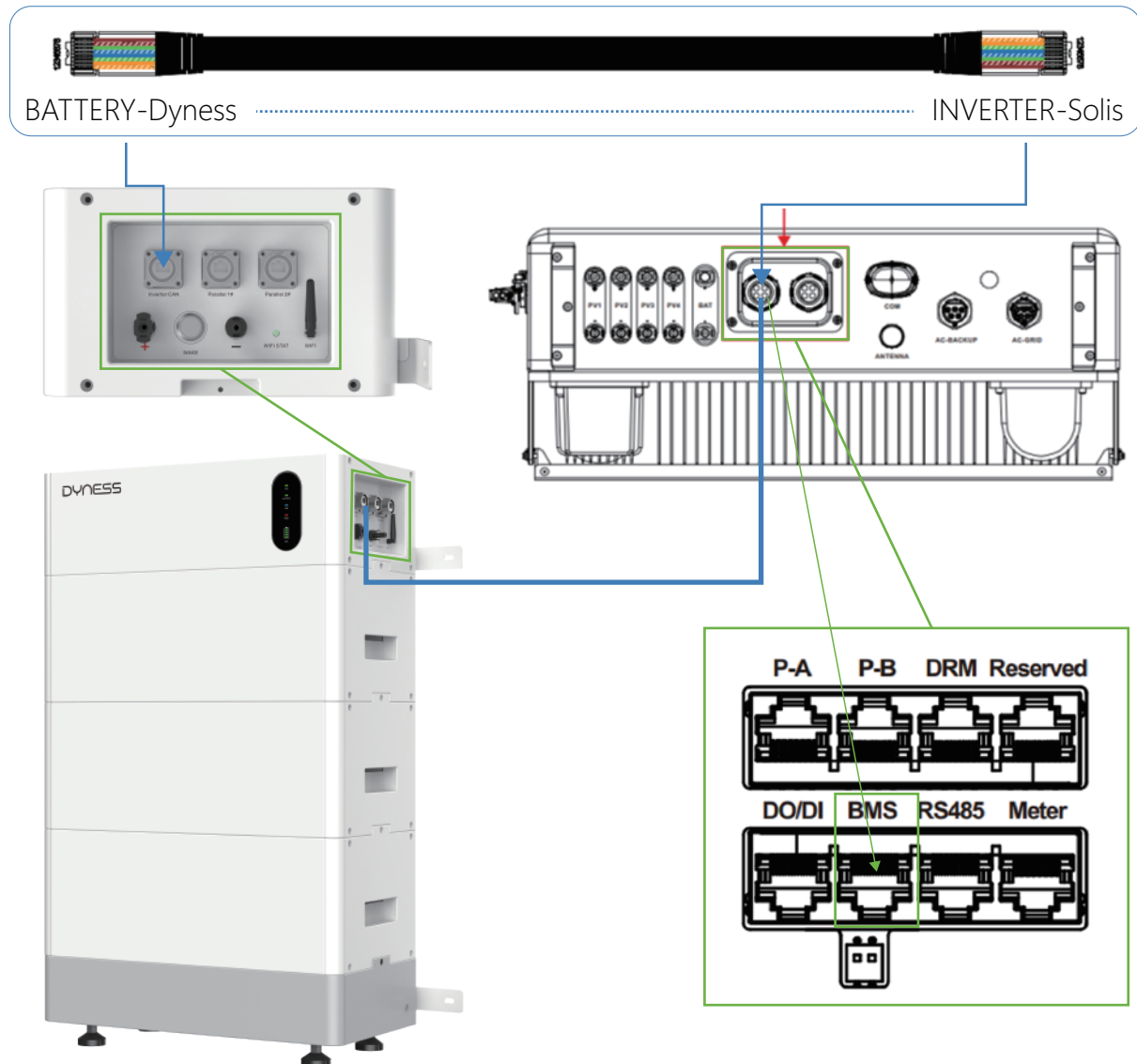

Connect between Tower Pro and Solis as below:

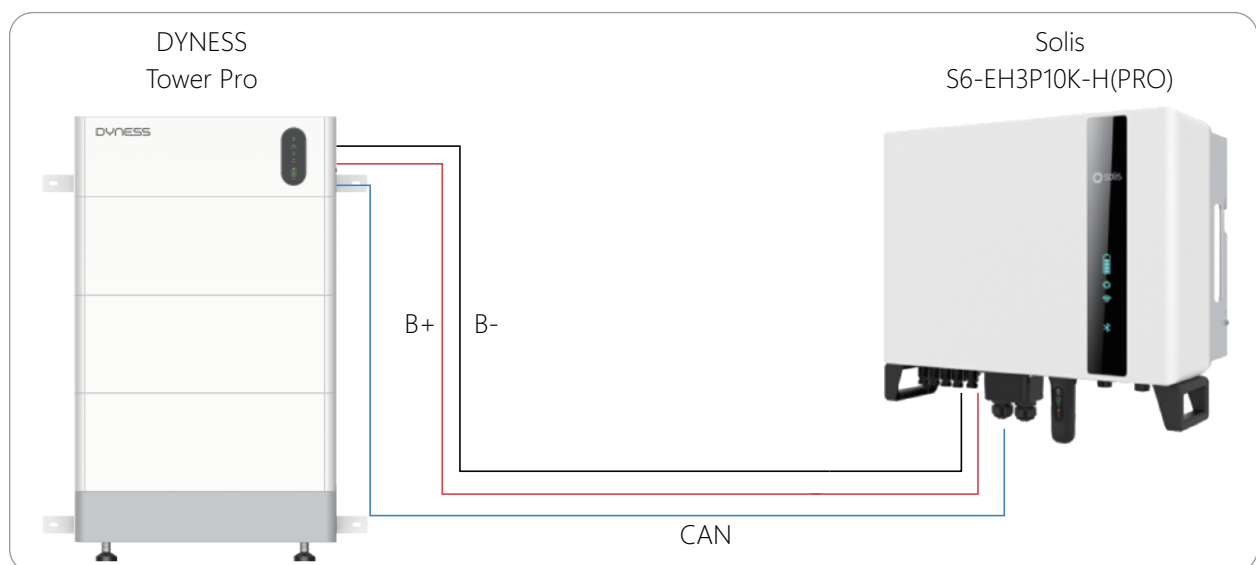

Tower Pro and Solis connection diagram

Step5: Turn on battery and inverter.

Turn on inverter: turn on circuit breaker of mains power to turn on Solis. Turn on the DC switch to "I" position.

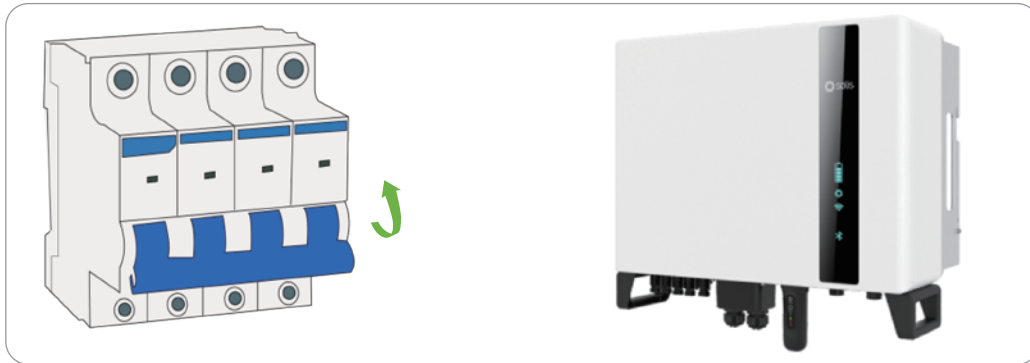

Turn on battery: Turn on the circuit breaker on BDU of tower pro, turn on the power on switch and press and hold on the "wake" button for 5s.

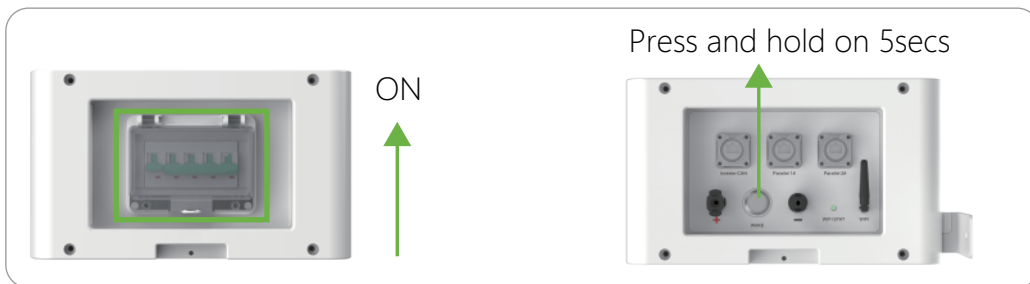

Step6: After the inverter is powered on, log in to the app "SolisCloud" to configure the network of the inverter. The detailed operation is as follows:(password:123456789):

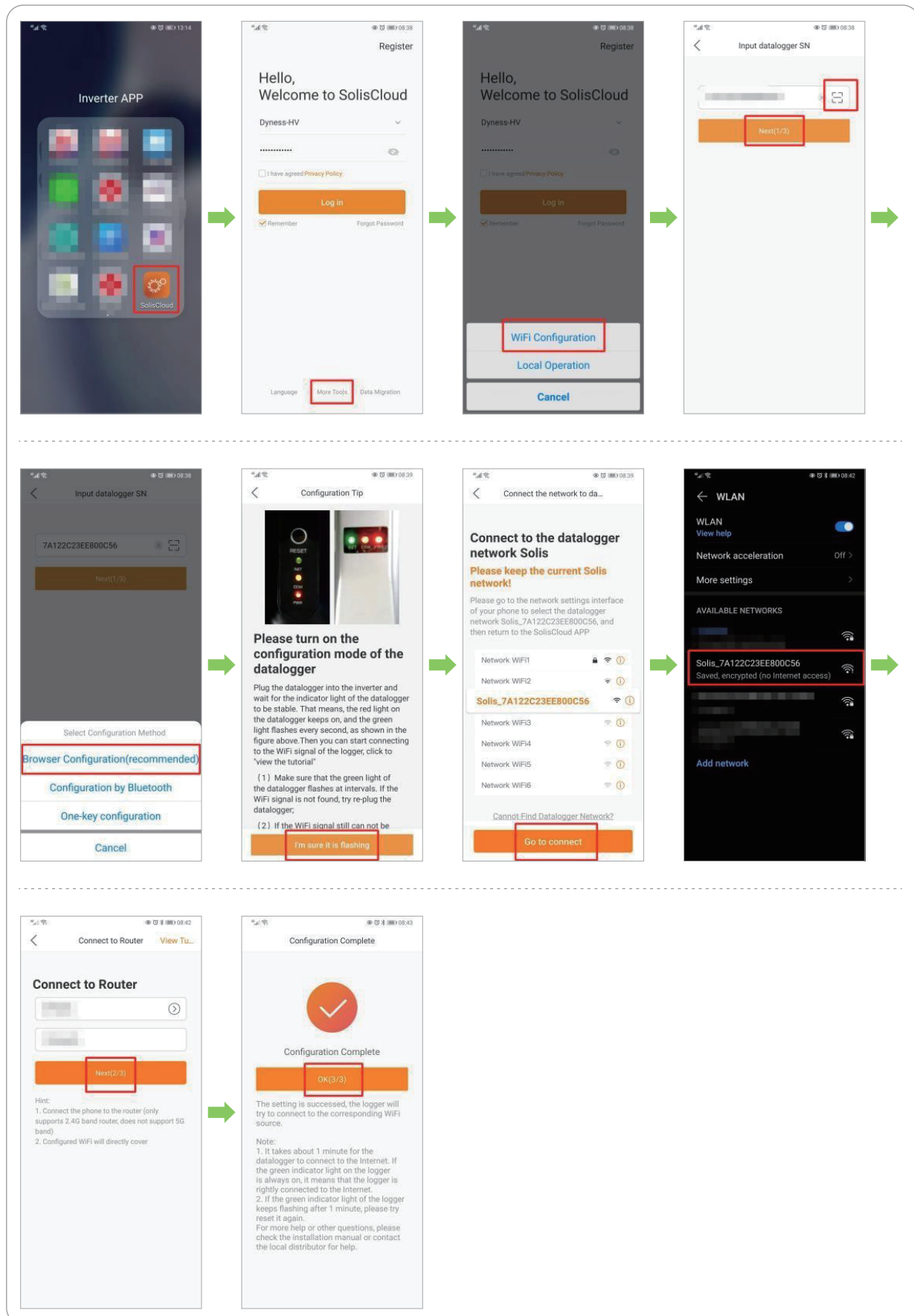

Step7: After the inverter network configuration is completed, it is necessary to set the time, battery model, meter type, etc. of the inverter. The detailed operation is as follows:

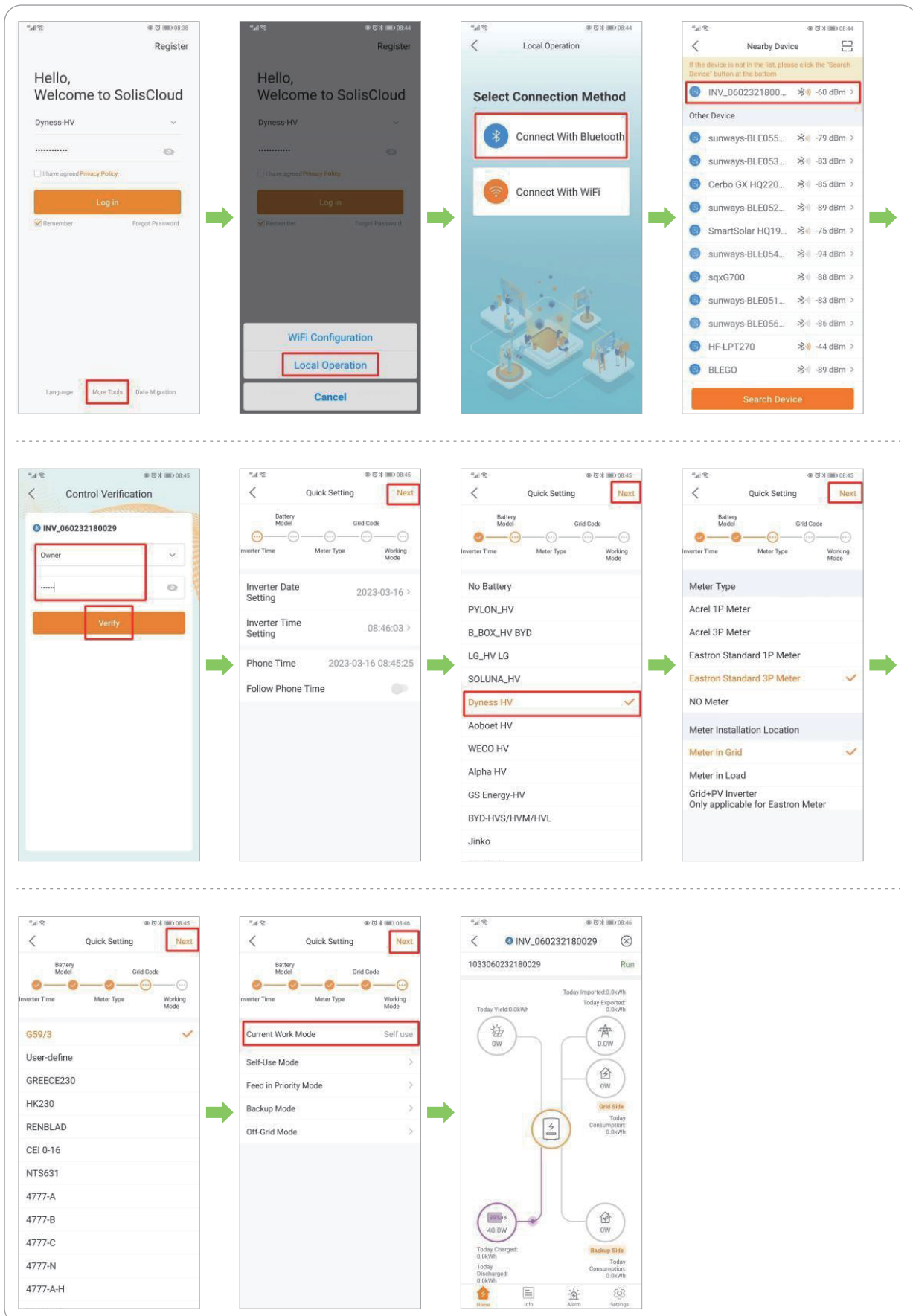

Step8: After the communication between the battery and the inverter is normal. You can query the power grid data after the power station is created in the app. The detailed operation is as follows:

AC Info			
	Voltage (V)	Current (A)	Frequency (Hz)
U	225.7	0	55.13
V	227.8	0	55.13
W	226	0	55.13

Inverter Info	
Model	3306
National Standard	GB/T 19914
Version	020002-000000
Full Load Hours	0 h
Warranty Period	—

Step10: In the app setting interface, select the self-use mode and set the charging and discharging time respectively. The detailed operation is as follows:
Charging settings:

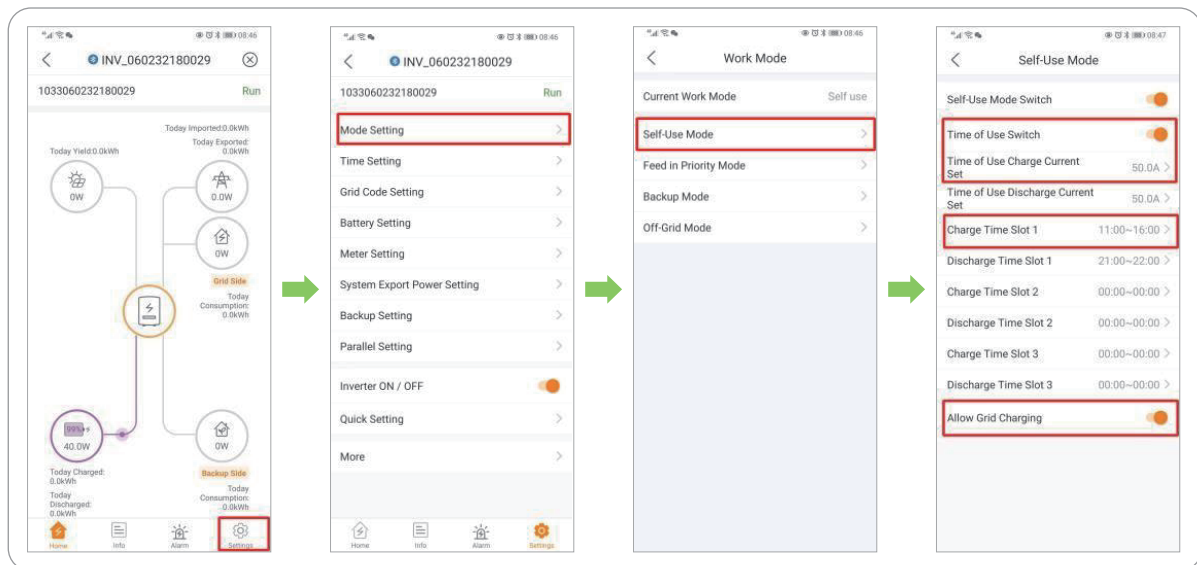

Discharging settings:

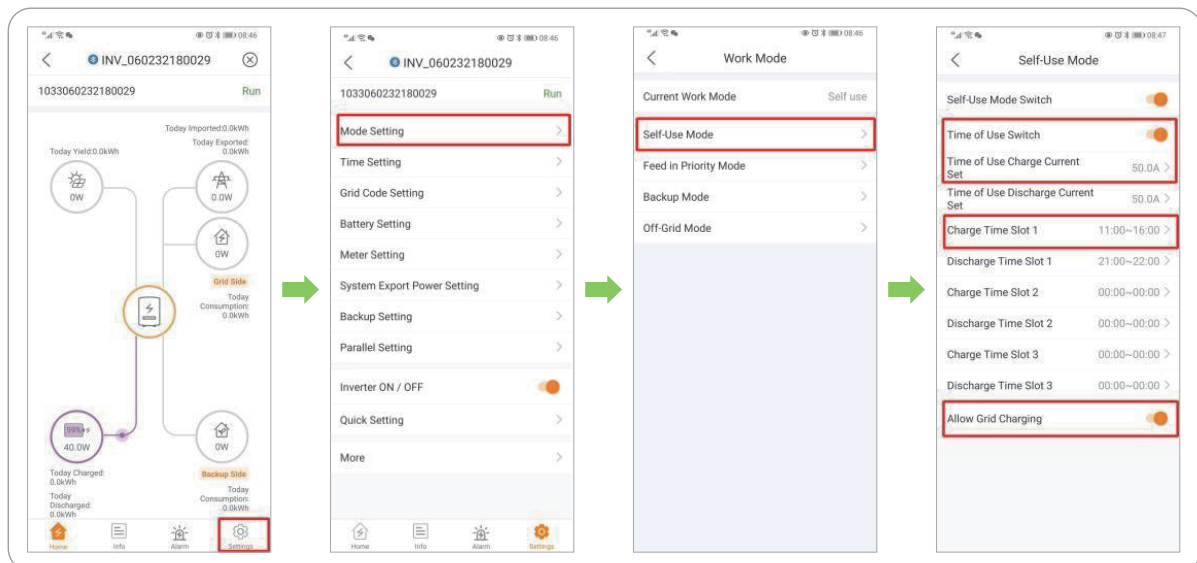

Step11: Off-Grid Mode Settings:

1. When the inverter is disconnected from the grid, it will automatically enter the off-grid mode, and the load can be connected to discharge.
2. Set offline mode in app:

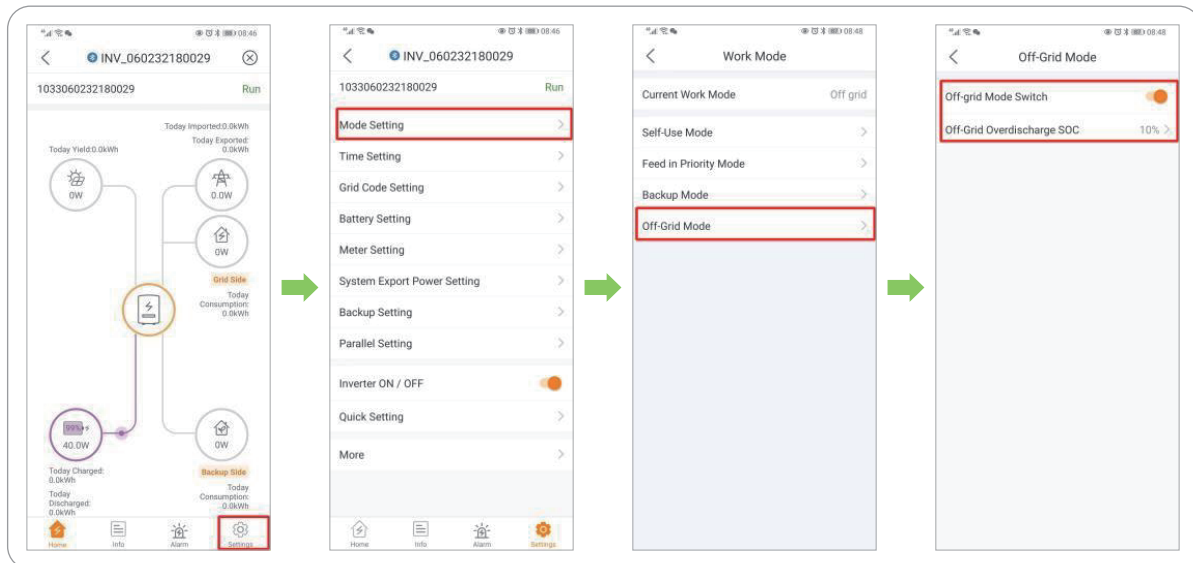



DISCOVER YOUR NATURE

Address: No.688, Liupu Road, Guoxiang Street, Wuzhong Economic
Development Zone, Suzhou, Jiangsu, China
Email: service@dyness-tech.com
Tel: +86 400 666 0655
Web: www.dyness.com



Official Website



Digital version access