

1. Product Introduction

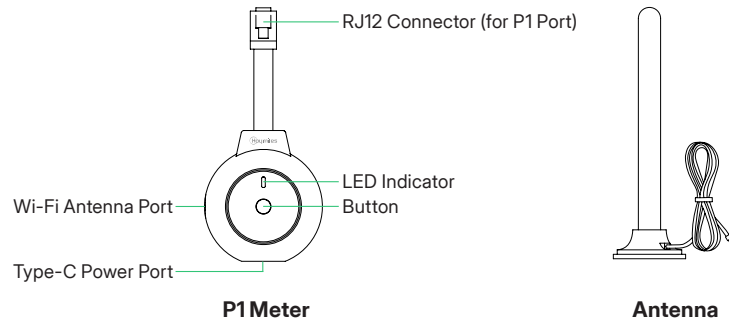

2. Button Functions

Action	Function
Press for 3 s	Turn on Bluetooth, and Bluetooth starts broadcasting.
Press once	Confirm Bluetooth connection.
Press for 10 s	Reset the device.

3. Status Indicators

LED	Time Gap	Indication
Alternating blue and green flashing	1 s	Upgrade mode
Alternating blue and green flashing	Blue: 2 s green: 0.5 s	Abnormal mode
Flashing blue	1 s	Bluetooth broadcasting
Flashing blue	0.5 s	Waiting for button confirmation to connect Bluetooth (Maximum waiting time: 15 s)
Solid blue	-	Bluetooth connected
Flashing green	2 s	Network not configured / Factory resetting
Flashing green	0.5 s	Network configured, connecting to network / Network connection failed
Solid green	-	Network connected, but no data communication
Solid green with blue flashing once per data transmission	-	Data communicating

4. Installation

Step 1: Insert the P1 meter into the P1 port of the smart meter. For the version 5.0 smart meter, if the P1 meter is powered on, the LED indicator will flash green.

Note: The actual position of the P1 port may vary depending on the smart meter, but it is typically labeled as "P1".

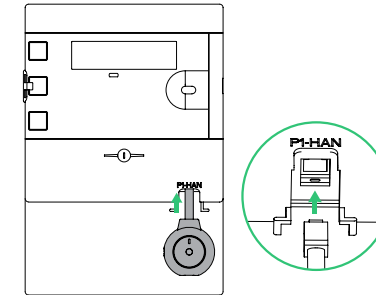

Step 2: For the version 4.0 smart meter, you need to connect the P1 meter to a power adapter (5 V, > 0.5 A) through the Type-C power port. If the P1 meter is powered on, the LED indicator will flash green.

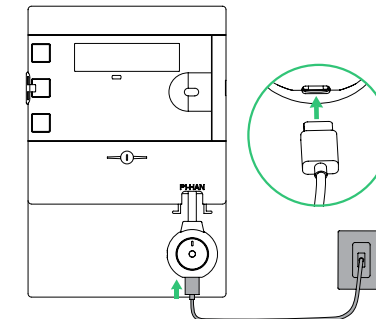

Step 3: Connect the magnetic mount antenna's cable to the P1 meter's Wi-Fi antenna port, and securely attach the antenna body to a nearby metal component.

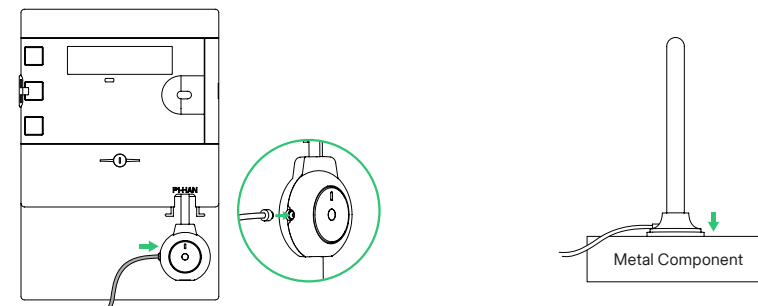

5. App Configuration

Note: The screenshots provided here are for reference only. The actual screens may vary.

Step 1: Scan the QR code on the right to download the S-Miles Home Application.

Step 2: Tap **+** > **Link Smart Device** > **Hoymiles Devices**.

Step 3: Press the button on the P1 meter for 3 s until the LED indicator flashes blue.

Step 4: Tap the device you want to add, and the LED indicator will flash blue at 0.5 s intervals.

Step 5: Press the button on the P1 meter within 30 s. When Bluetooth is connected, the LED indicator will be solid blue.

Step 6: Enter or select the Wi-Fi name, and enter the password. Then tap **Next**.

Step 7: When the connection is successful, the LED indicator will be solid green. Then tap **Next**.



Step 2-1

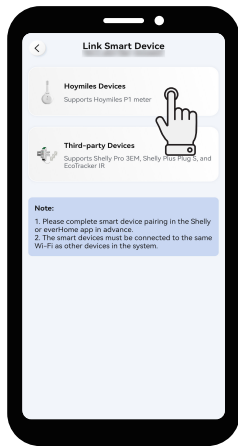

Step 2-2

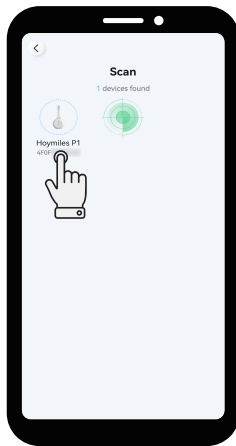

Step 4

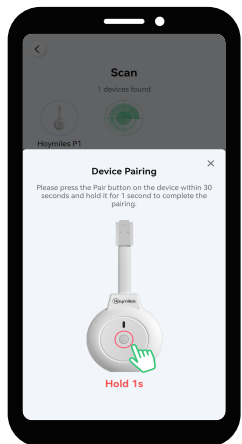

Step 5

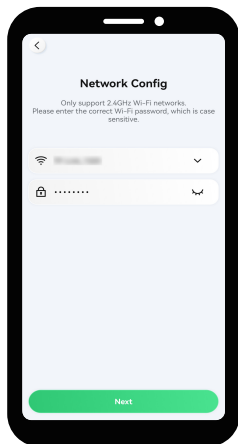

Step 6

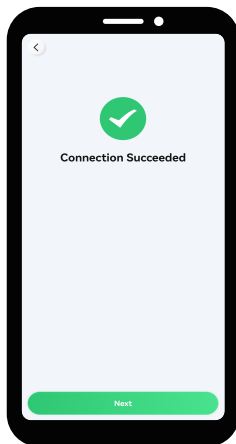

Step 7

Step 8: Tap the micro storage device.

Step 9: Tap the P1 meter.

Step 10: Enter the name for the P1 meter, and tap **Confirm**.

Step 11: Tap **Finish** to complete device adding. Or Tap **Continue adding** to add more devices.

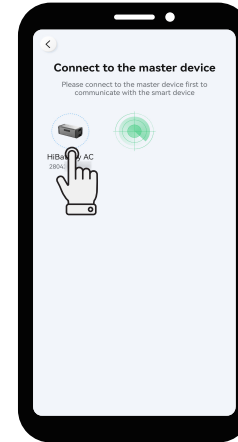

Step 8

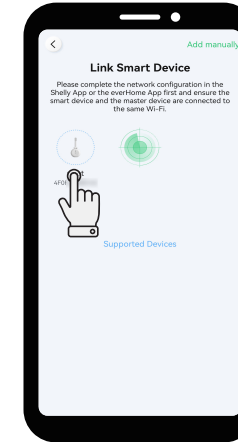

Step 9

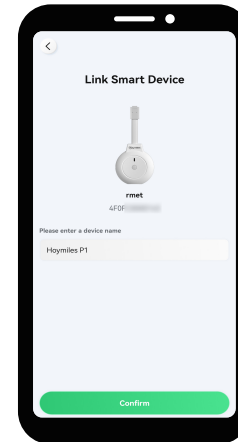

Step 10

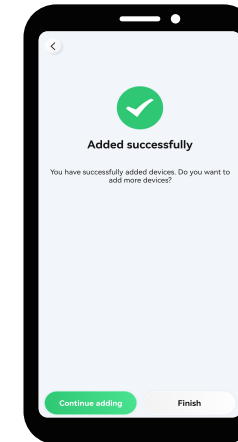

Step 11



CE Declaration of Conformity

Hoymiles P1 meter (model: HMeter-P1-W) is a class B product. In a domestic environment, this product may cause radio interference, in which case the user may be required to take adequate measures. The Wi-Fi module frequency band of the P1 meter is 2400 MHz to 2483.5 MHz. ERP < 14 dBm.



EU Declaration of Conformity

Hoymiles P1 meter (model: HMeter-P1-W) is in compliance with the essential requirements and other relevant provisions of directives 2014/53/EU, 2009/125/EC, 2011/65/EU and (EU)2015/863. The original EU Declaration of Conformity may be found at <https://www.hoymiles.com/download-center.html>.